

Product Code
SDS-TW-001-12
SDS-TW-001-24

Nominal Dimensions
 1" X 12" and 1" X 24"

Description

The updated #1 Through-Wall Kit provides a one-inch through-wall pathway in multiple installation scenarios, including:

- SDS 2"x2" Raceway to SDS 2"x2" Raceway
- SDS 2"x2" Raceway to User Drop Box or other enclosure
- User Drop Box to User Drop Box or other enclosure

The newer components provide maximum inside diameter, smoother cable movement, and a powder-coated trim ring and coupler for a more finished appearance.

 [Installation Instructions](#)

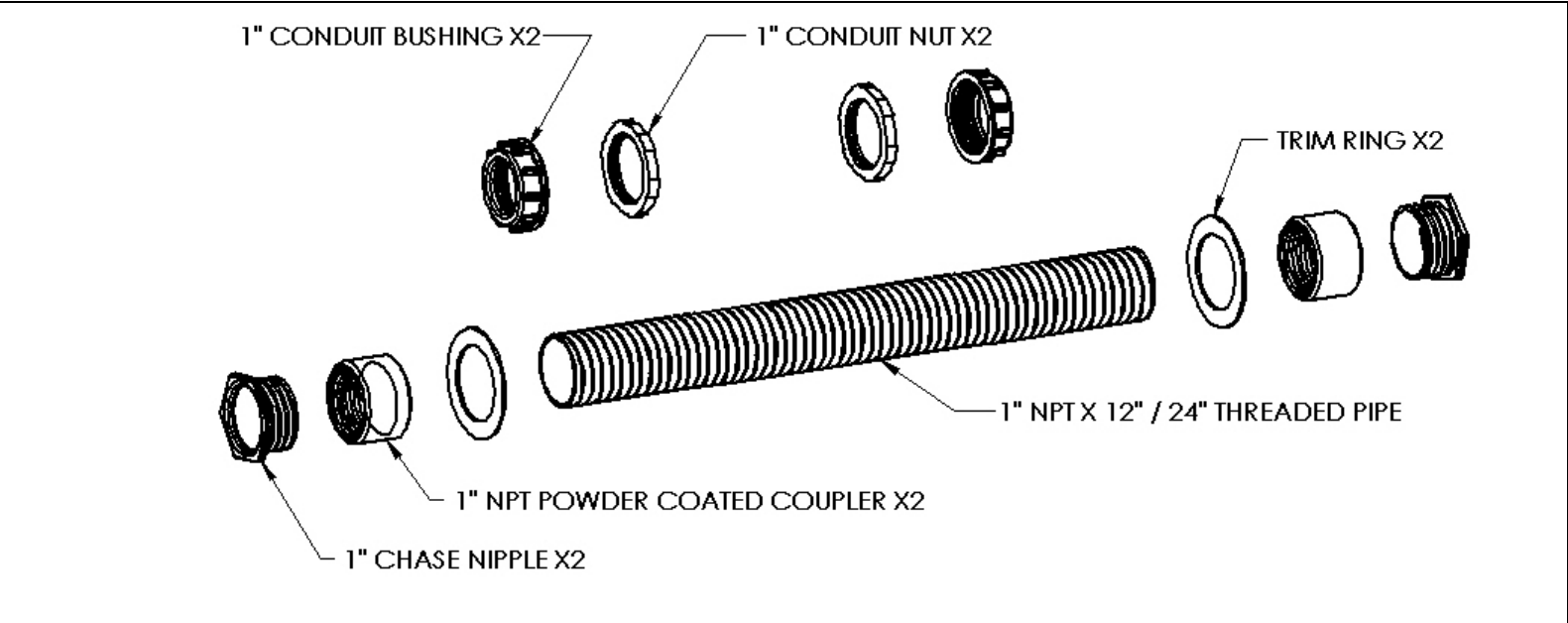

Specifications

	12"	24"
	<ul style="list-style-type: none"> • Galvanized steel threaded pipe 	<ul style="list-style-type: none"> • Galvanized steel threaded pipe
	<ul style="list-style-type: none"> • Total weight: 2 lbs 	<ul style="list-style-type: none"> • Total weight: 3 lbs
	Through-Wall Kit includes:	Through-Wall Kit includes:
	<ul style="list-style-type: none"> • One (1) – 1" x 12" NPT threaded pipe 	<ul style="list-style-type: none"> • One (1) – 1" x 24" NPT threaded pipe
	<ul style="list-style-type: none"> • Two (2) – 1" conduit bushings 	<ul style="list-style-type: none"> • Two (2) – 1" conduit bushings
	<ul style="list-style-type: none"> • Two (2) – 1" conduit lock nuts 	<ul style="list-style-type: none"> • Two (2) – 1" conduit lock nuts
	<ul style="list-style-type: none"> • Two (2) – 1" NPT powder-coated couplers 	<ul style="list-style-type: none"> • Two (2) – 1" NPT powder-coated couplers
	<ul style="list-style-type: none"> • Two (2) – 1" Chase nipples 	<ul style="list-style-type: none"> • Two (2) – 1" Chase nipples
	<ul style="list-style-type: none"> • Two (2) powder-coated trim rings 	<ul style="list-style-type: none"> • Two (2) powder-coated trim rings



Holocom, Inc.
www.holocom.com

PRODUCT CODE:
SDS-TW-001-12 / SDS-TW-001-24

TITLE:
#1 THROUGH-WALL KIT

All material contained in this document is the property of Holocom, Inc. and may not be reproduced or transmitted (including electronically) without the written consent of Holocom, Inc. Holocom and the Holocom logo are registered trademarks of Holocom, Inc. Other noted marks are trademarks of their respective companies. Holocom products protected by US Pats. D619,097; D632,763; D580,871; 7,608,780; 7,661,375; 7,183,488; 7,115,814; 7,053,303; 7,049,517; 6,838,616; 5,831,211 and pats pending. Made in the U.S.A. Copyright © 2012 Holocom, Inc. All rights reserved.