

Product Code
SDS-TW-005-12
SDS-TW-005-24

Nominal Dimensions
 1" X 12" and 1" X 24"

Description

The updated #5 Through-Wall Kit provides a 1" through-wall pathway in multiple installation scenarios including:

- SDS 2" x 2" Raceway to SDS 2" x 2" Raceway
- SDS 2" x 2" Raceway to Secure Mini Dukt™ (SMD) Tubing
- SDS 2" x 2" Raceway to User Drop Box or other enclosure

The newer components provide maximum inside diameter, smoother cable movement, and powder-coated trim ring and coupler for a more finished appearance.



[Installation instructions](#)

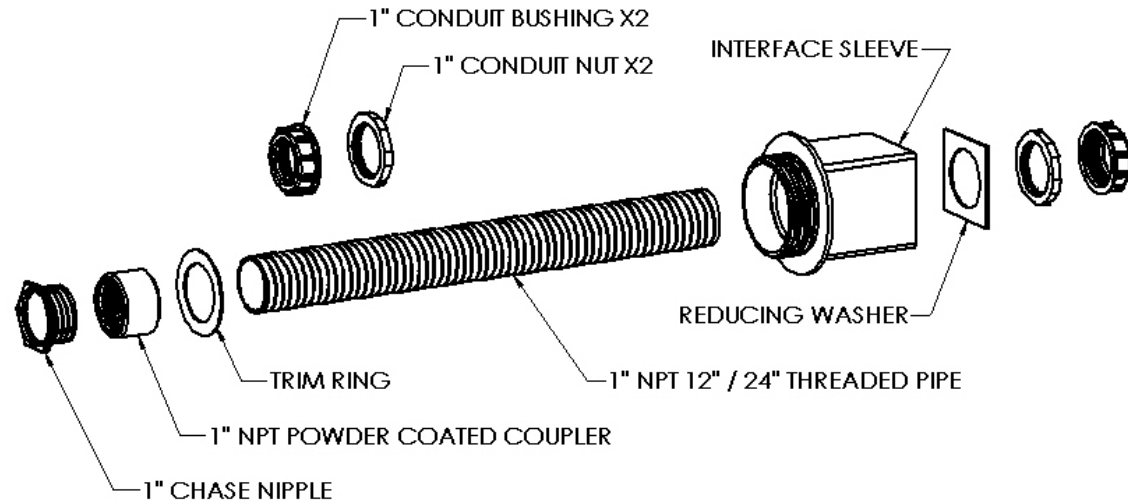

Specifications

12"	24"
<ul style="list-style-type: none"> • Galvanized steel threaded pipe • Total weight: 3 lbs 	<ul style="list-style-type: none"> • Galvanized steel threaded pipe • Total weight: 4 lbs
Through-Wall Kit includes:	Through-Wall Kit includes:
• One (1) – 1" x 12" NPT threaded pipe	• One (1) – 1" x 24" NPT threaded pipe
• Two (2) – 1" conduit bushings	• Two (2) – 1" conduit bushings
• Two (2) – 1" conduit lock nuts	• Two (2) – 1" conduit lock nuts
• One (1) reducing washer	• One (1) reducing washer
• One (1) interface sleeve	• One (1) interface sleeve
• One (1) 1" NPT powder-coated coupler	• One (1) 1" NPT powder-coated coupler
• One (1) Chase nipple	• One (1) Chase nipple
• One (1) powder-coated trim ring	• One (1) powder-coated trim ring



Holocom, Inc.
www.holocom.com

PRODUCT CODE:

SDS-TW-005-12 / SDS-TW-005-24

TITLE:

#5 THROUGH-WALL KIT

All material contained in this document is the property of Holocom, Inc. and may not be reproduced or transmitted (including electronically) without the written consent of Holocom, Inc. Holocom and the Holocom logo are registered trademarks of Holocom, Inc. Other noted marks are trademarks of their respective companies. Holocom products protected by US Pats. D619,097; D632,763; D580,871; 7,608,780; 7,661,375; 7,183,488; 7,115,814; 7,053,303; 7,049,517; 6,838,616; 5,831,211 and pats pending. Made in the U.S.A. Copyright © 2012 Holocom, Inc. All rights reserved.